

BALLUFF

sensors worldwide

BOS 12M Thru-beam Laser Sensor

... precise, powerful, rugged

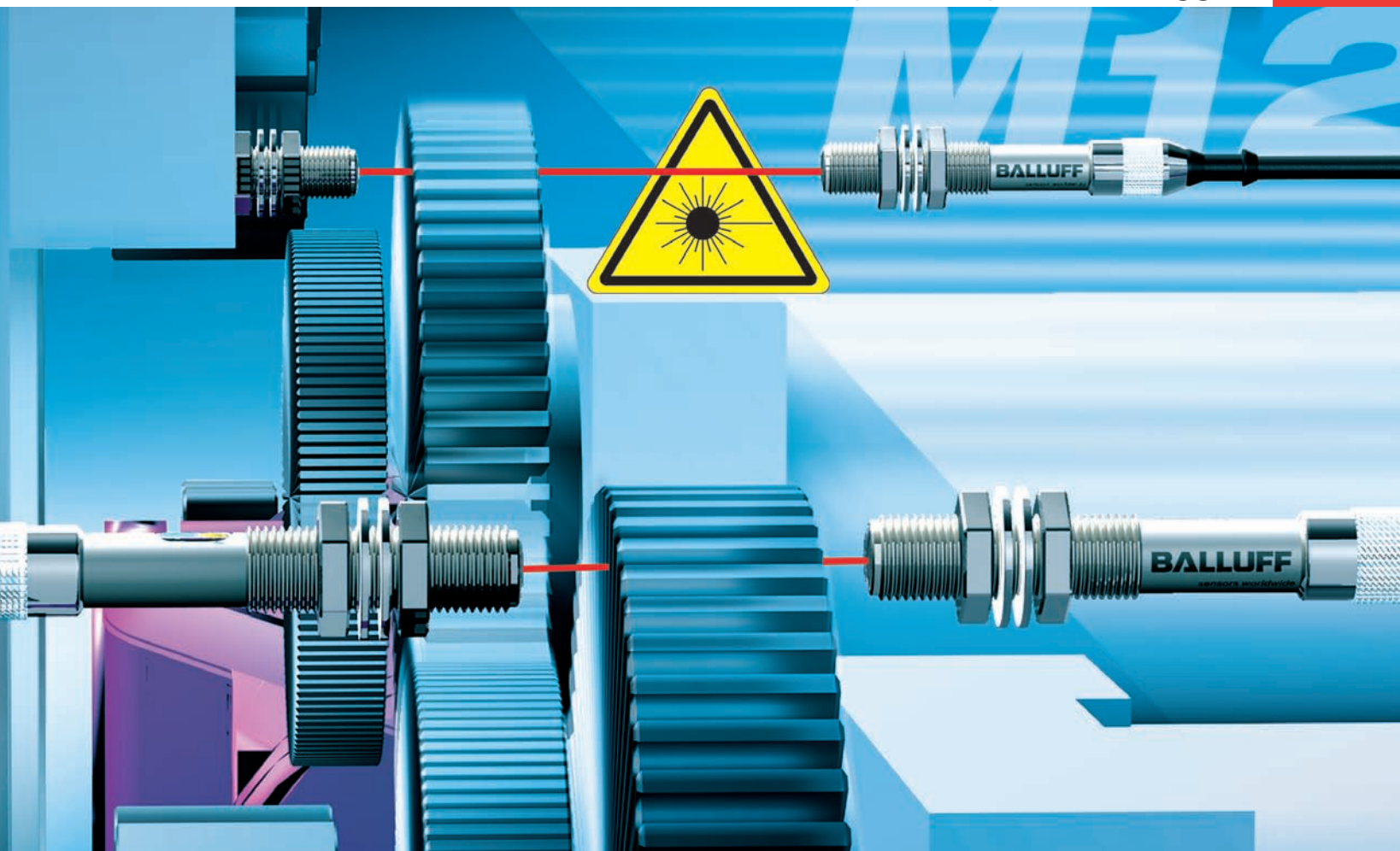

BOS 12M Thru-Beam Laser Sensor

... precise, powerful, rugged



Type		Emitter	Emitter	Receiver
Application		Small parts detection	Long range	
Thru-beam	Range	3 m	30 m	
	Focal point	50 cm	n.a.	

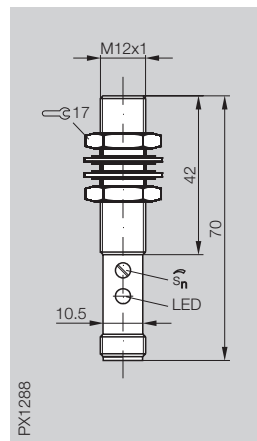
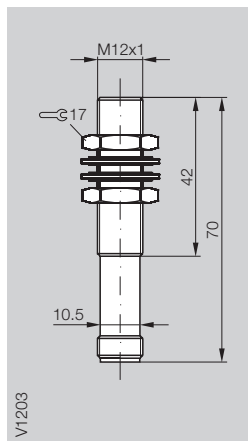
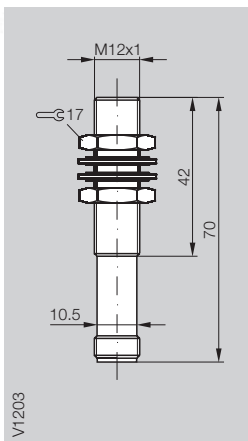
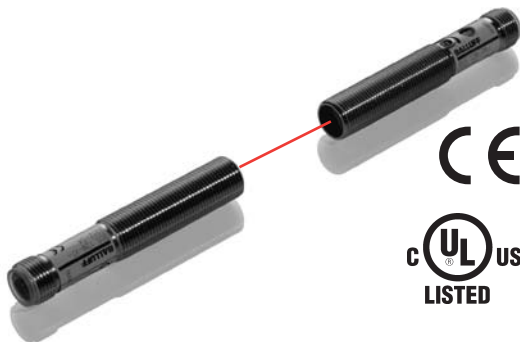

Thru-beam

Emitter	Small parts detection	BOS 12M-X12-S4	
	Long range		BOS 12M-X12-S4
Receiver	PNP		BOS 12M-PA-LE10-S4
	NPN		BOS 12M-NA-LE10-S4

Electrical data

Supply voltage U_B	10...30 V DC	10...30 V DC	10...30 V DC
Output current			≤ 200 mA
Switching output			PNP or NPN transistor
Output function			Light-on and dark-on
Settings			Potentiometer 270°
Switching frequency			1 kHz

Optical data

Emitter, light source	Visible Class I Laser	Visible Class I Laser	
Wavelength	655 nm	655 nm	

Indicator

Output function indicator			Yellow LED
---------------------------	--	--	------------

Mechanical data

Connection	M12 connector, 4-pin	M12 connector, 4-pin	M12 connector, 4-pin
Housing material	Nickel plated brass	Nickel plated brass	Nickel plated brass
Sensing face material	Glass	Glass	PMMA

Ambient data

Degree of protection per IEC 60529	IP 67	IP 67	IP 67
Reverse polarity protected/short circuit protected	yes/yes	yes/yes	yes/yes
Ambient temperature range T_a	-10...+50 °C	-10...+50 °C	-10...+50 °C

- Two versions optimized for small part and feature detection or long range detection
- Precise, highly visible laser beam provides range up to 30 meters
- Extremely small light spot detects objects or features down to 50 μ m
- Class I Laser technology
- Metal housing combines inductive sensor durability with laser photoelectric accuracy

Wiring diagrams

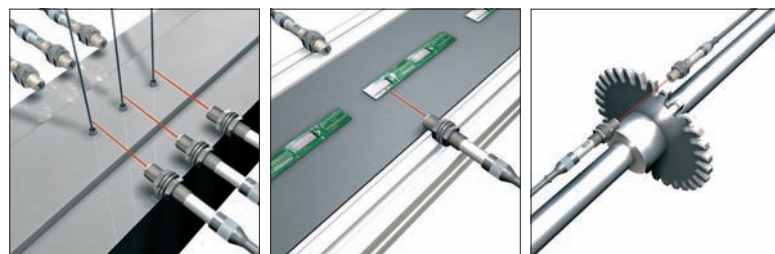
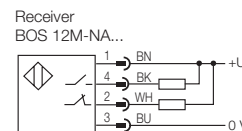
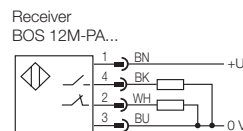
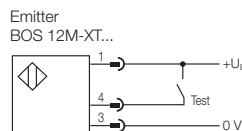

5772 Smaller Rd, Johnstown, OH 43031 Phone: (740) 967-2283 Fax: (740) 967-2855
Website: www.gordyssensors.com or Email: sales@gordyssensors.com